

INSTALLATION

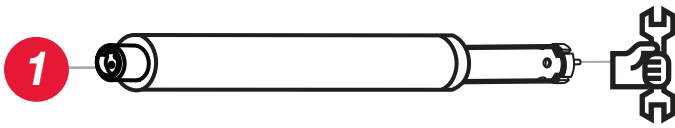

1 MOUNT AND WIRE HEATER

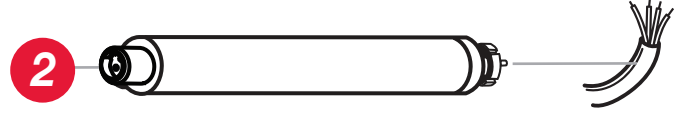

2 CONNECT GROUNDING WIRE

Connect the ground wire to the green grounding nut on the housing assembly.



3 CONNECT AIR SOURCE TO HEATER

Connect the filtered air source to the heater.

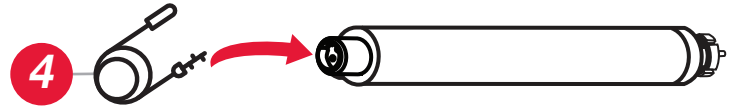

4 OPTIONAL EXTERNAL THERMOCOUPLE PLACEMENT

If a thermocouple is used, ensure that it is located within one inch from the heater exit. Tutco SureHeat recommends using an exposed junction type K thermocouple like Part # F039272. Contact Tutco SureHeat for specifications.

START-UP

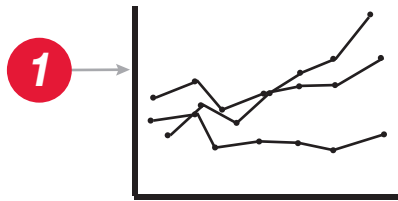

1 REFERENCE PERFORMANCE CURVES



2 TURN ON AIR

Set pressure or flow to desired operating level.

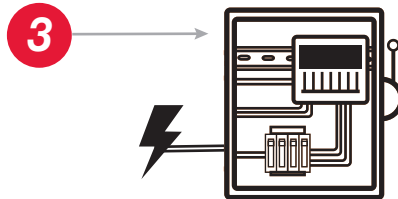

3 ENERGIZE MAIN POWER LINE

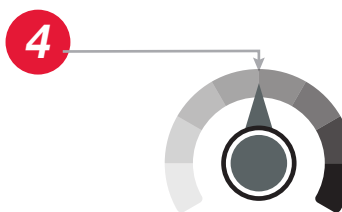

4 SET DESIRED TEMPERATURE

SHUT-DOWN

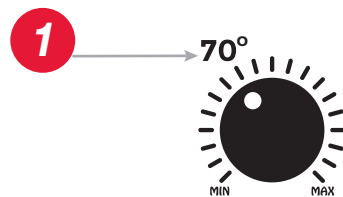

1 RETURN SET-POINT TEMPERATURE

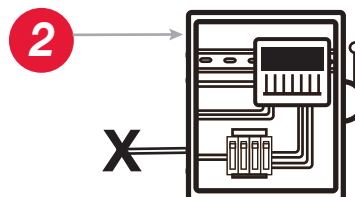

2 TURN OFF MAIN POWER



3 CONTINUE AIR FLOW

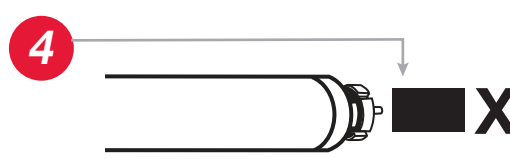

4 TURN OFF AIR TO SYSTEM

DOWNLOAD
MANUAL

